

双面四色印刷

LITTLE NATION

Toddler Crib Bed Rail Guard

Instruction Manual

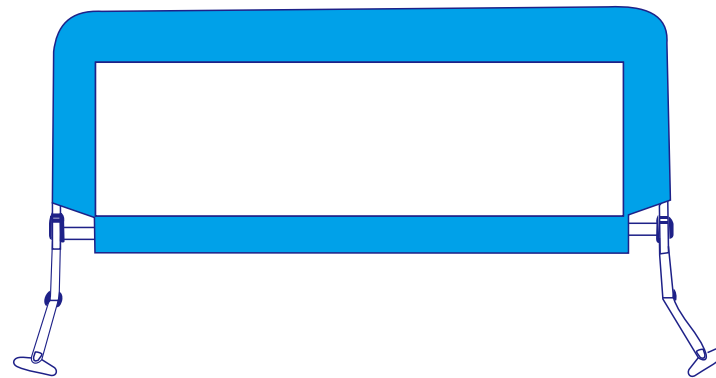

What is a crib bed rail guard?

As one of the most necessary furnitures in most advanced countries, a crib bed rail guard is used to prevent sleeping toddlers from falling down from the bed which would result in possible injuries. This product is useful for toddlers who sleep in adult beds besides their parents. The bed rail guard can be rotated, folded and adjusted once installed on the bed. It also offers a convenient way for getting the toddler in and out of the bed. The crib bed rail guard allows the growing toddler to sleep soundly without the risk of getting injured.

210.00 mm

285.00 mm

210.00 mm

Please read carefully the written instructions below before using the crib bed rail guard. Note that the crib rail guard is suitable for 0-8 years old.

Parts/component drawing:



Nylon Mesh (X1);

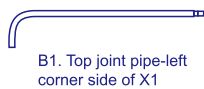

B1. Top joint pipe-left corner side of X1

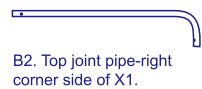

B2. Top joint pipe-right corner side of X1.



C1. Bottom joint pipe-left corner side of X1



C2. Bottom joint pipe-right corner side of X1.



D1. Standing leg - left side of X1.

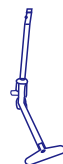

D2. Standing leg - right side of X1.

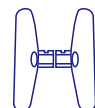

E. X2

How to assemble crib bed rail guard.

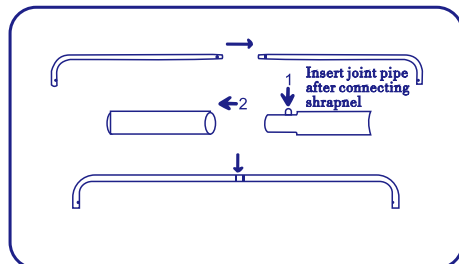

1. Join together the B1 and B2 parts to form the top joint pipe.

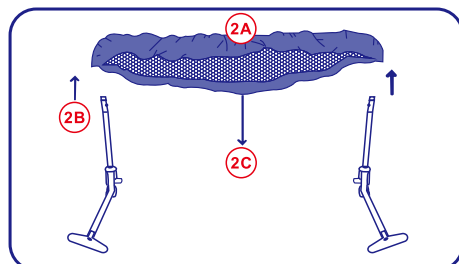

2. A. Insert the top joint pipe through the nylon mesh (A).
B. Connect the standing legs (D1 and D2) at both sides of the nylon mesh (A).
C. Pull down the nylon mesh (A).

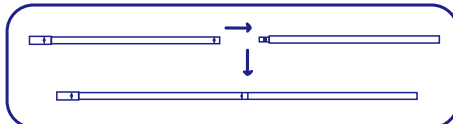

3. Join together the bottom joint pipes, C1 and C2.

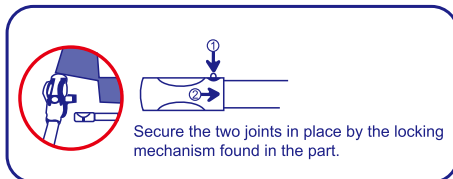

4. The bottom joint pipe would be inserted at the bottom of the nylon mesh (A).
Note: turn over the nylon mesh (A) while keeping the nylon mesh (A) flat when installing the bottom joint pipe. Once the bottom joint pipe are at the erect position, tighten the nylon mesh (A).



5. Finish the assembly.

Assembly and reinforcement drawing for the standing leg

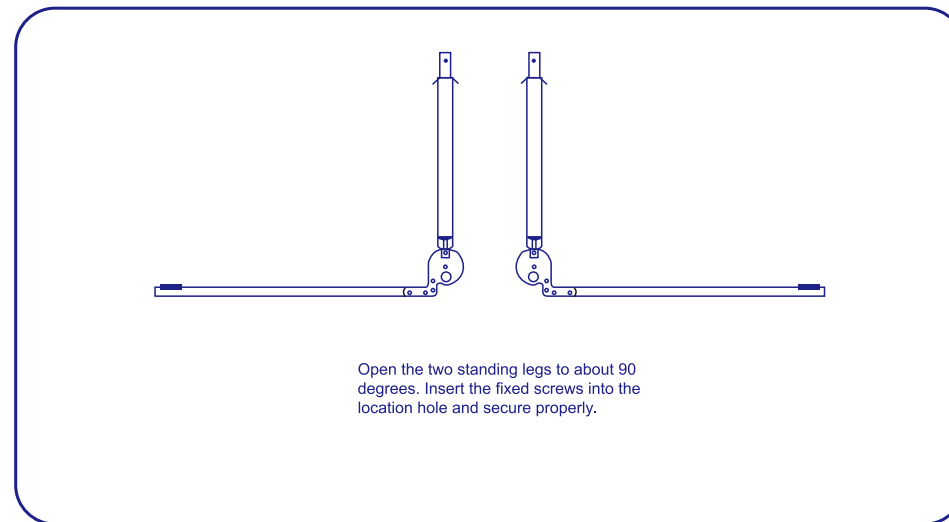

Open the two standing legs to about 90 degrees. Insert the fixed screws into the location hole and secure properly.

Using the crib bed rail guard:

1. Lift the gear of the joint on one side
2. Pull the other end of the bed rail guard at the other side of the bed. This would allow one person to fold the crib guard rail.
3. Note that the proximity of crib guard rail to the bed depends on the height of the bed and the width of the bed edge.

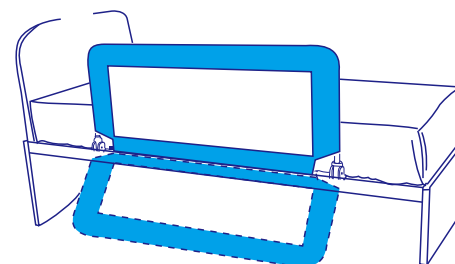

How to maintain the crib bed rail guard

1. Use the bed mattress to pin the standing leg of the crib bed rail guard.
2. The crib bed rail guard can fold when not in use.
3. When cleaning the crib bed rail guard, use wet towel at the surface. Nylon Mesh can be removed and wash in intervals.



Warning

1. Improper use of the product may lead to accidental suffocation of the baby and maybe even result in serious injuries.
2. Careful handling of the product is necessary. Never allow the baby to play with the product to avoid any untoward accidents.
3. Never put the baby on top of the bed without the crib bed rail guard.
4. Place all packaging materials inside the packing box. Secure the box properly.

285.00 mm